

# DC BRUSHLESS FAN

## CC-8015 SERIES

### FEATURES

SIZE:	80×80×15 mm
BEARING TYPE:	BALL , SLEEVE & ONE BALL & ONE SLEEVE BEARING
IMPELLER:	PLASTIC WITH FIBER GLASS FILLED UL 94V-0
FRAME:	PLASTIC WITH FIBER GLASS FILLED UL 94V-0
WEIGHT:	50(g)

### PERFORMANCE & DIMENSIONS

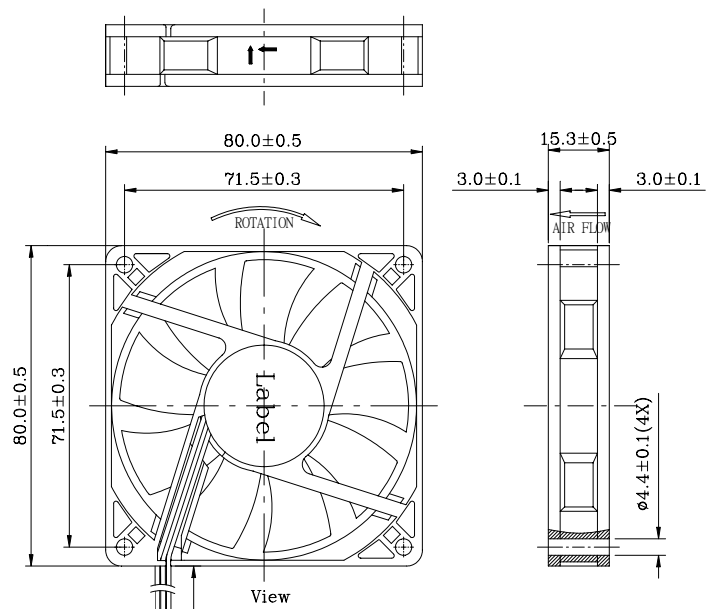
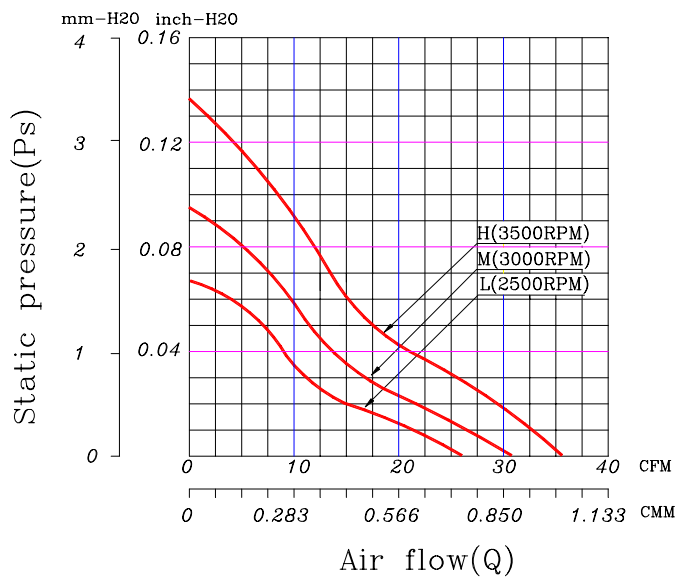

Model No.	Bearing	Rated Voltage (VDC)	Current (A)	Input Power (Watts)	Air Flow (CFM)	Speed (RPM)	Noise Level (dBA)	Dimensions
								L×W×H (mm)
CC 8015S12H	Sleeve	12	0.25	3	35.77	3500	35.5	80*80*15
CC 8015B12H	2 Ball	12	0.25	3	35.77	3500	36	80*80*15
CC 8015C12H	1B1S	12	0.25	3	35.77	3500	36	80*80*15
CC 8015S24H	Sleeve	24	0.18	4.32	35.77	3500	35.5	80*80*15
CC 8015B24H	2 Ball	24	0.18	4.32	35.77	3500	36	80*80*15
CC 8015C24H	1B1S	24	0.18	4.32	35.77	3500	36	80*80*15
CC 8015S12M	Sleeve	12	0.19	2.28	31.25	3000	32	80*80*15
CC 8015B12M	2 Ball	12	0.19	2.28	31.25	3000	32.5	80*80*15
CC 8015C12M	1B1S	12	0.19	2.28	31.25	3000	32.5	80*80*15
CC 8015S24M	Sleeve	24	0.13	3.12	31.25	3000	32	80*80*15
CC 8015B24M	2 Ball	24	0.13	3.12	31.25	3000	32.5	80*80*15
CC 8015C24M	1B1S	24	0.13	3.12	31.25	3000	32.5	80*80*15
CC 8015S12L	Sleeve	12	0.16	1.92	25.96	2500	26.5	80*80*15
CC 8015B12L	2 Ball	12	0.16	1.92	25.96	2500	27	80*80*15
CC 8015C12L	1B1S	12	0.16	1.92	25.96	2500	27	80*80*15
CC 8015S24L	Sleeve	24	0.11	2.64	25.96	2500	26.5	80*80*15
CC 8015B24L	2 Ball	24	0.11	2.64	25.96	2500	27	80*80*15
CC 8015C24L	1B1S	24	0.11	2.64	25.96	2500	27	80*80*15