

INSTALLATION

组件

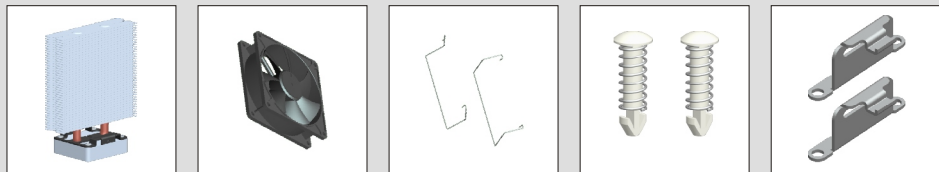

散热器

风扇

弹簧 1
(安装风扇用)

插销

滑槽

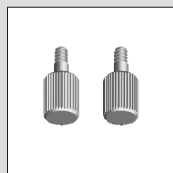

螺柱

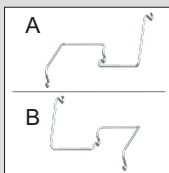

弹簧 2
(安装散热器用)



导热膏

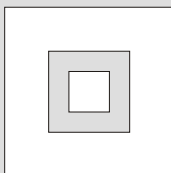

垫片

安装风扇

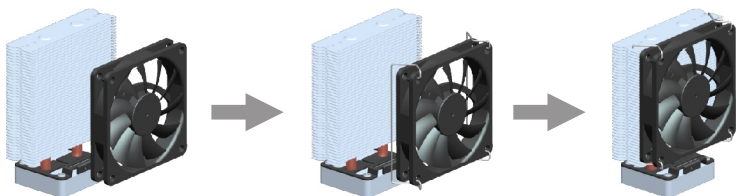

插孔安装图

Step 1

将导热膏均匀涂在GPU上。



Step 2

将回形垫片贴在GPU周围，并检查您的主板孔位的距离。

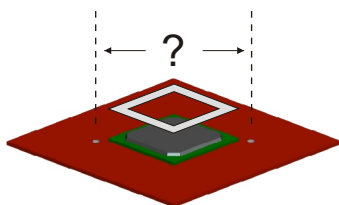

Step 3

—— 装上滑槽：
—— 调整孔位的距离：
—— 安装好插销。

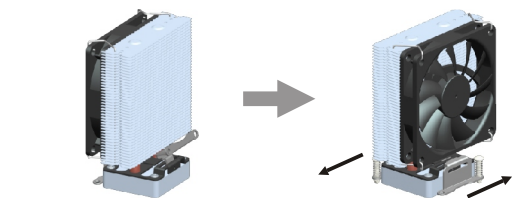

Step 4

调整好孔位的距离后，拧紧螺柱。

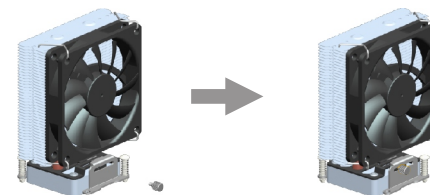

Step 5

把插销插在主板的孔位上。

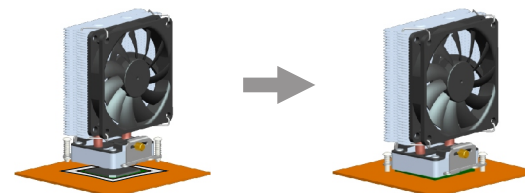

弹簧的安装图

Step 1

将导热膏均匀涂在GPU上。

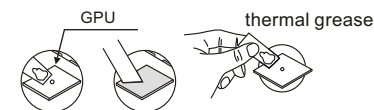

Step 2

根据您的主板选择弹簧A或者弹簧B。

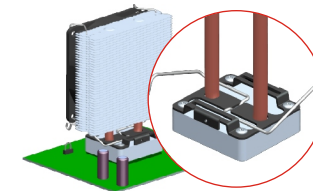

Step 3

将回形垫片贴在GPU周围，并扣好弹簧。

